

Community Meeting
July 31, 2018
Public Art/New Public Service Building

AGENDA

6:00 Welcome, Meeting Overview, Peter Brown

6:10 Public Art Overview, Mary Altman and Tristan Al-Haddad

- Feedback from Public Meeting 3
- Artistic Opportunities Throughout the Building
- Introducing Tristan Al-Haddad
- Atrium Sculpture Concept
- Question and Answer
- Input
- Next Steps

6:45 Building Update, Matthew Kruntorad

7:00 Adjourn



- Co-locates employees and services from several locations in downtown.
- At 501 Fourth Avenue South.
- Serves employees, service center clients, nearby neighbors and the City's diverse residents.
- Construction-fall of 2018, Complete-summer 2020, Open to the public-fall 2020.
- Design team: MSR (Meyer, Scherer & Rockcastle) and the international firm Henning Larsen.

New Public Service Building



New Public Service Building PUBLIC ART GOALS

- Create a public space that is **inviting**, pleasant and compelling for visiting businesses and residents.
- Reflect the **culture and diversity of the city** through history and storytelling.
- Reflect the **mission of public service**, the City's commitment to transparency and educate the public about the City services.
- Support a **work environment** that promotes wellness, a diversity of work styles, collaboration and innovation.



New Public Service Building PUBLIC ART GOALS

- Be thoughtfully **integrated** into the architectural identity and design, materials, and palette.
- Be contemporary, yet **timelessly elegant**, and meaningful.
- Enhance the **focal points**, entrances, plazas and wayfinding systems.
- Celebrate the **sustainability** goals of this project and the facility.
- Be **durable and maintainable**.



New Public Service Building PUBLIC ART PHASE ONE

- Artist **Tristan Al-Haddad** (Formations Studio) selected.
- To identify **public art opportunities** within the building.
- To design and fabricate a **signature piece** (atrium).
- Has identified over **30 possible opportunities**.



New Public Service Building Excerpts and Votes 4.18.18 Community Meeting

Atrium/26 Dots:

- Do not crowd, confound or block light.
- Something memorable like Father of Waters or the Spoon Bridge and Cherry.

Luminous Ceilings/20 Dots

- Do not crowd, confound or block light.

Mural Glass/19 Dots

- Depiction of historic events and people can become dated.

Glass Frit/18 Dots:

- Use to expand on the natural streetscape.

Least Votes: Door Pulls/1 dot



- Artist to design patterning for portions of the bird-safe glass frit.
- Locations have not been finalized.
- Deadline: August 3

New Public Service Building BIRD SAFE GLASS DESIGN National Call



- Be a sophisticated, **timeless** for 75-Year civic building.
- Be an abstract geometric pattern.
- Use a white frit.
- Complement interior and exterior design
- Integrate with the frit for the rest of the building.

New Public Service Building BIRD SAFE GLASS DESIGN National Call



New Public Service Building BIRD SAFE GLASS DESIGN National Call

- Read from a distance and up close, create a play of light and shadow on the interior spaces.
- Be successful **as the light changes** throughout the day.
- Meet **stated criteria** in terms of transparency and percentage of area covered by the pattern.

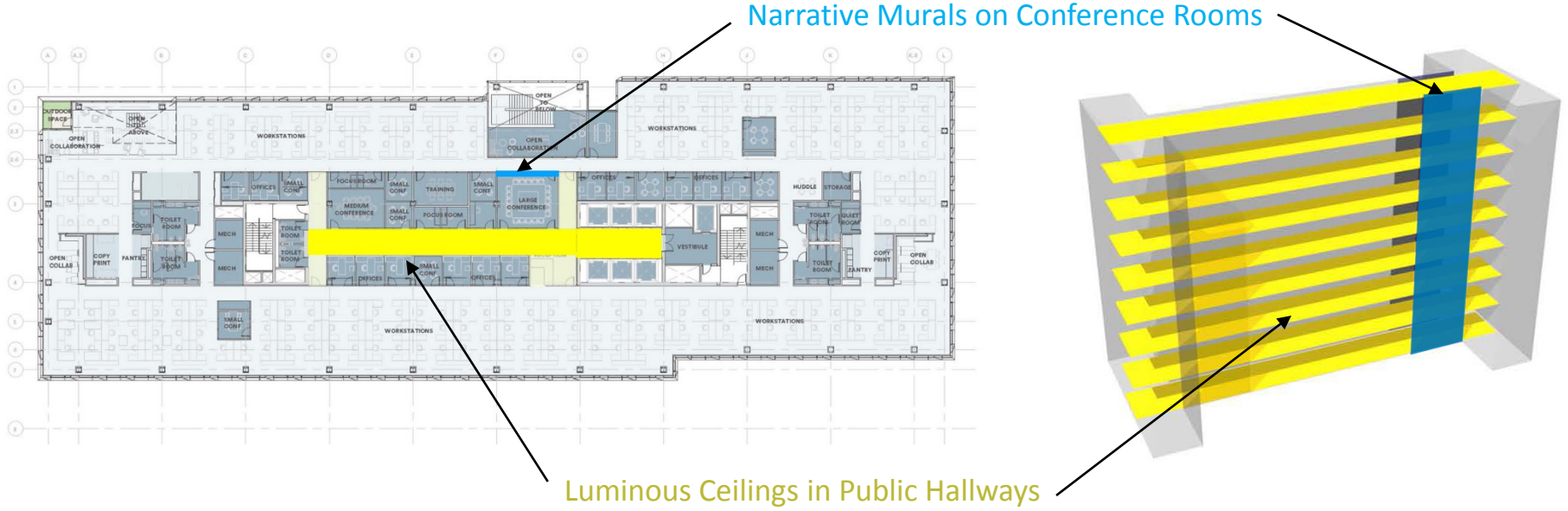

Upcoming Opportunities ART CORE (Murals and Ceilings)



Upcoming Opportunities

NARRATIVE MURALS ON GLASS

Local Call



- Narrative in nature.
- Portions could repeat on the hallway glass, in lieu of standard pattern.
- Needs include translucent, opaque and open spaces; avoid a sense of claustrophobia.
- Should complement interior and core ceiling designs.

Upcoming Opportunities

NARRATIVE MURALS ON GLASS

Local Call

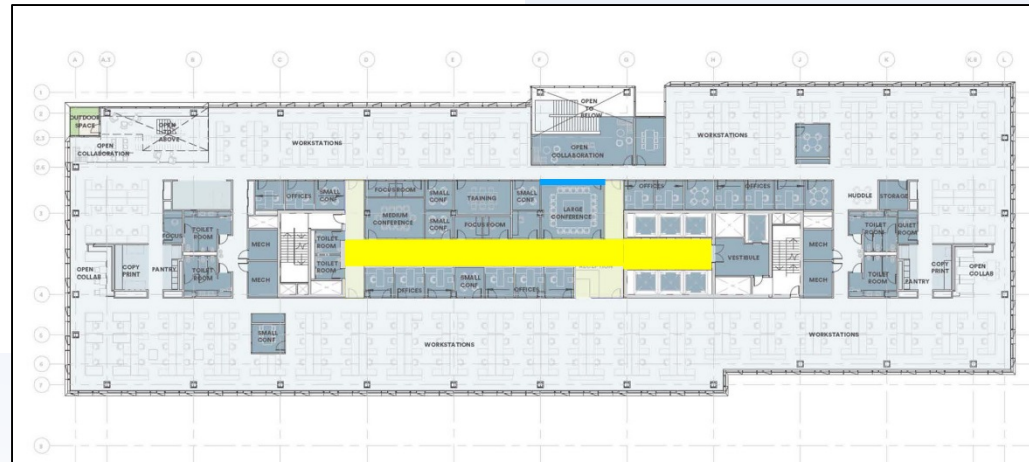
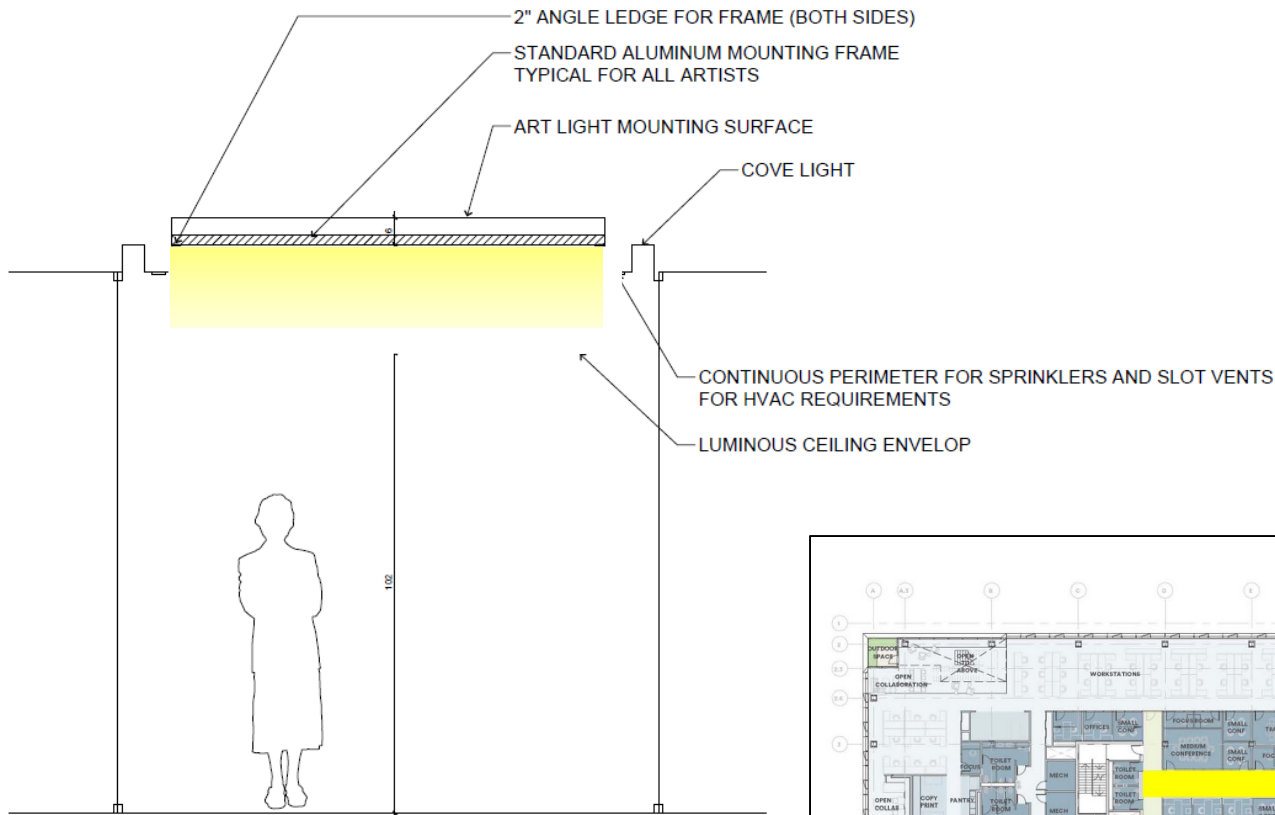

Upcoming Opportunities

LUMINOUS CEILINGS

Local Call

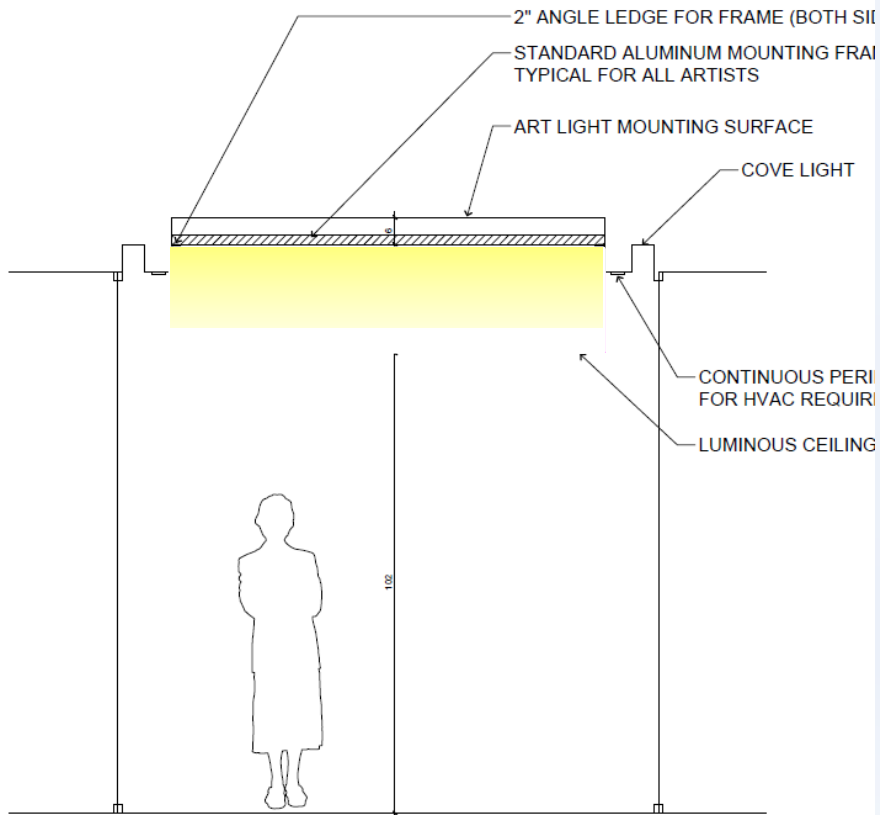

- Abstract in nature.
- Lit from above.
- Could be in natural materials, as well as others.
- Attaches to base framework.
- Size, weight and height constraints.
- Should complement interior and core ceiling designs.

Upcoming Opportunities

LUMINOUS CEILINGS

Local Call

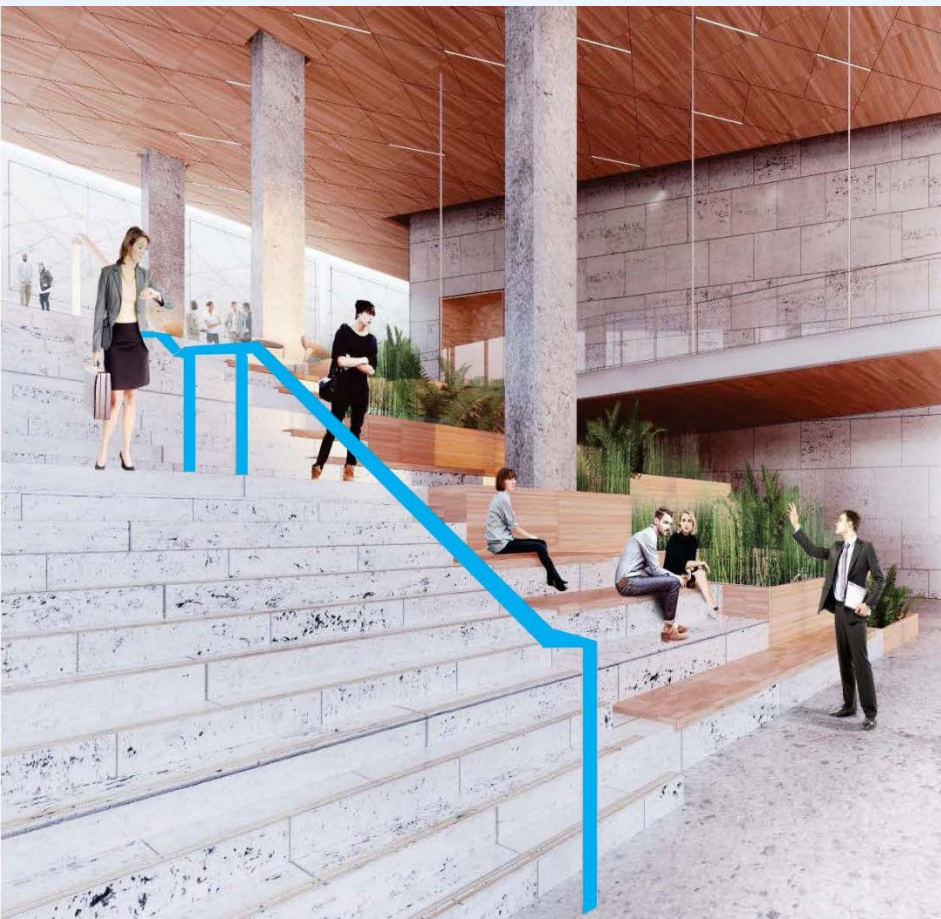

- Opportunity to engage local craftspeople.
- Should complement interior designs and materials.
- Needs to be in a material that is durable given continuous handling
- Should comply with all codes.

Upcoming Opportunities

HAND RAIL AND DRINKING FOUNTAINS

Local Call

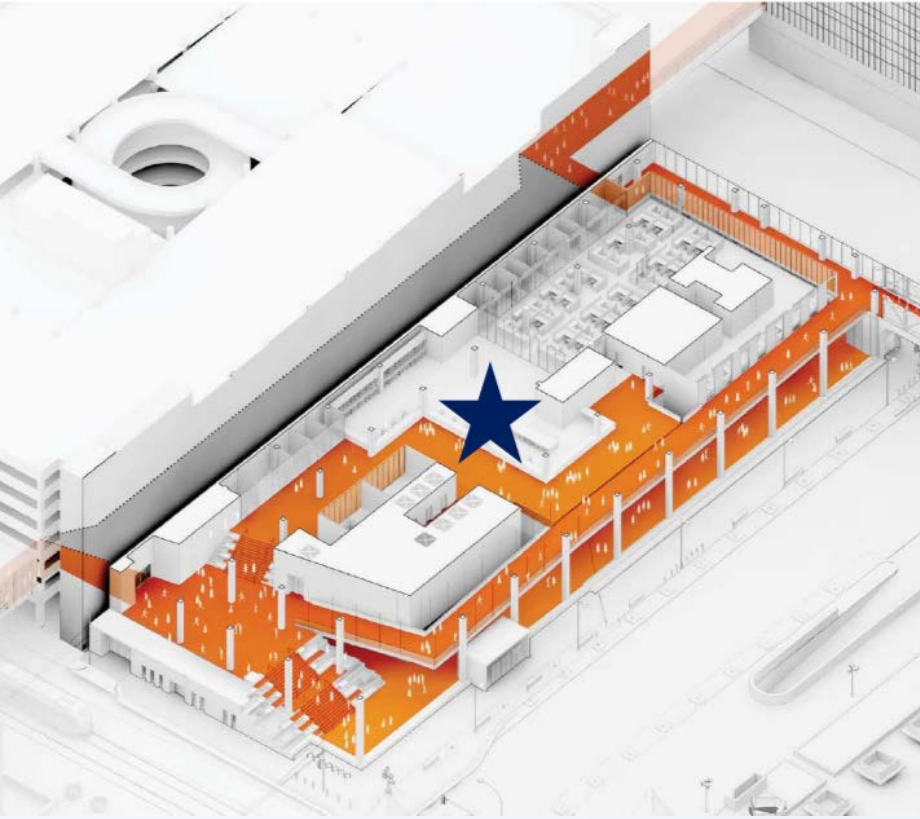

- Commissions by local artists to create short media works.
- To be projected on a display system in the Public Service Center.
- Should be appropriate to users who are waiting, and may visit on an ongoing basis.

Upcoming Opportunities

MEDIA WORKS

Local Call



New Public Service Building
ATRIUM ARTWORK
Tristan Al-Haddad

- Expresses the climatic conditions of the city through continuous movement and change to be experienced and contemplated over time.
- Suspended within the two story atrium (material and color to be determined)
- Large ephemeral vaulted form within the two-story atrium.
- Connects to the design's focus on the Minneapolis natural environment (stone, lakes, tree canopy and sky.)

New Public Service Building

ATRIUM ARTWORK

“Current Conditions”

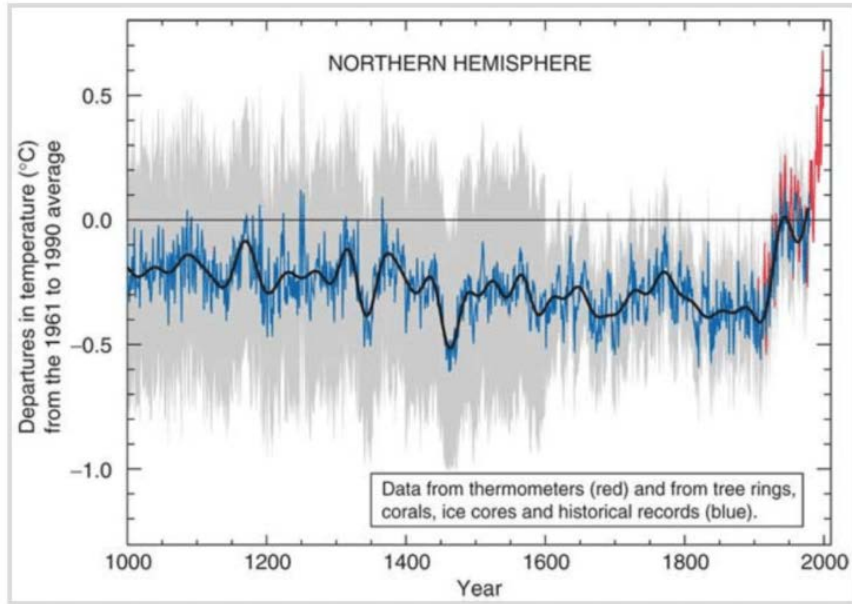

- Linked to real-time information (collected on the roof) and conditions related to the Minneapolis sky (such as temperature, color, humidity, and particulate/pollution.)
- Will register in changes in the movement of the work, mapping daily, seasonal and annual cycles, and perhaps even time frames across decades.

New Public Service Building ATRIUM ARTWORK Linkage to Real-time Information

Greenhouse Gas Emissions from Citywide Activities in Minneapolis

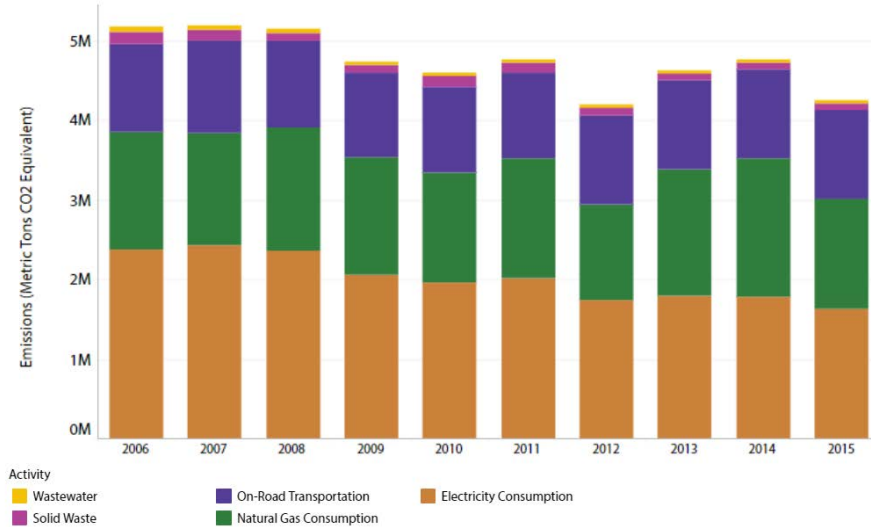

Source: City of Minneapolis

- The environment and its resources are a key concern of the citizens of the City, and will continue to be.
- They are also the focus of the work of many of the people in the building.
- The City's draft comprehensive plan currently calls for an 80% reduction in greenhouse gas emissions by 2050.

New Public Service Building ATRIUM ARTWORK Connection to Workers and Citizens

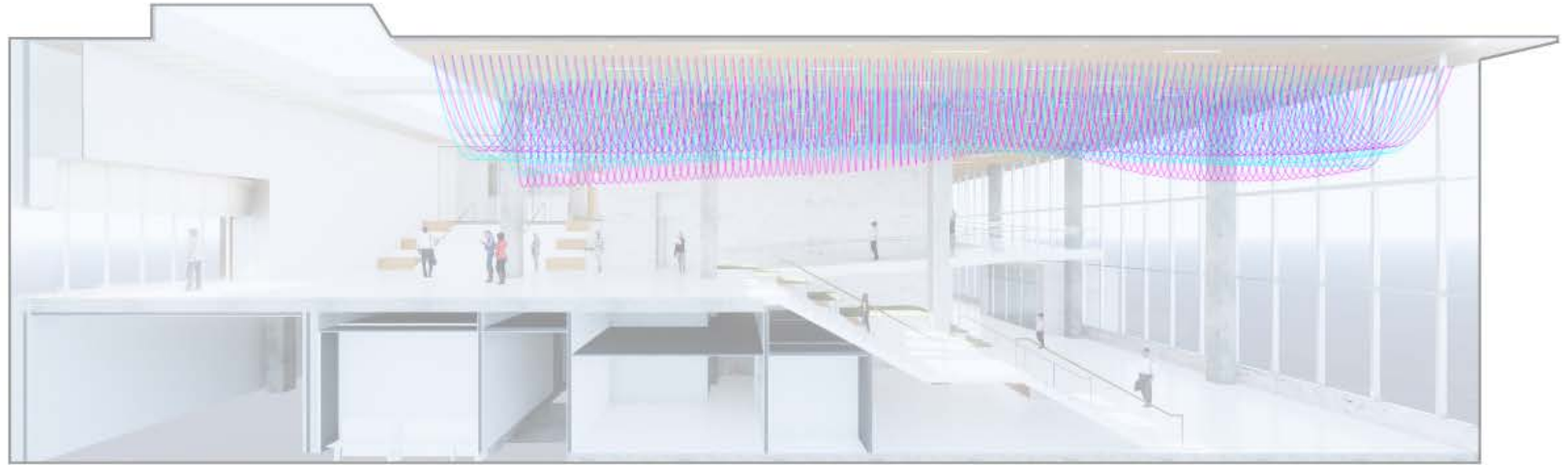

New Public Service Building ATRIUM ARTWORK Viewer's Experience

- Abstract, but accessible to a broad range of people from diverse cultural backgrounds.
- Could be experienced and contemplated overtime.
- Draws awareness to our collective role as stewards of the environment.

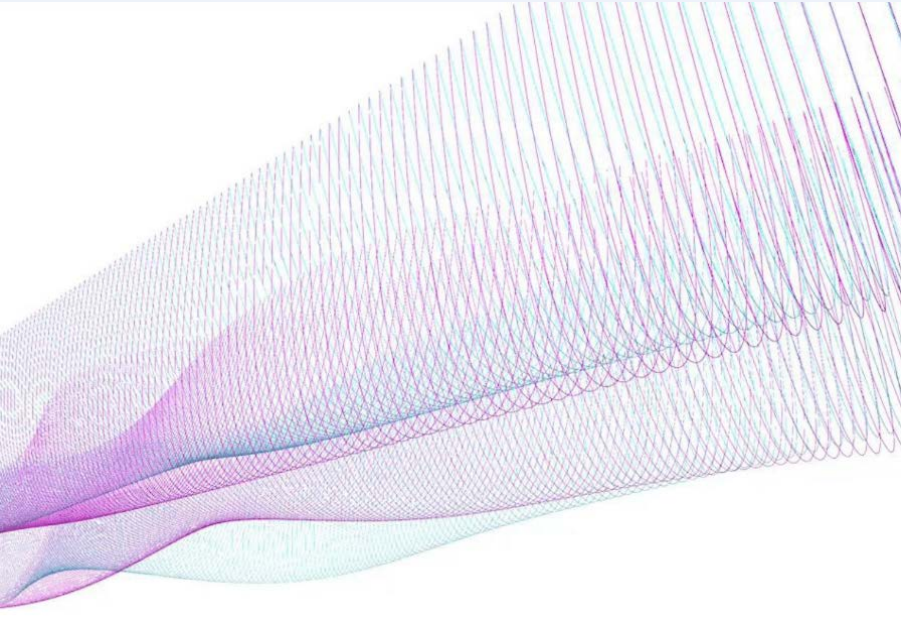

Questions

- What aspects of climate change do you think would be the most meaningful for the artwork to respond to, now and in 50 years?

MSR + Henning Larsen



Public Service Area (PSA)



1 View of service counters

2 View of entry from skyway

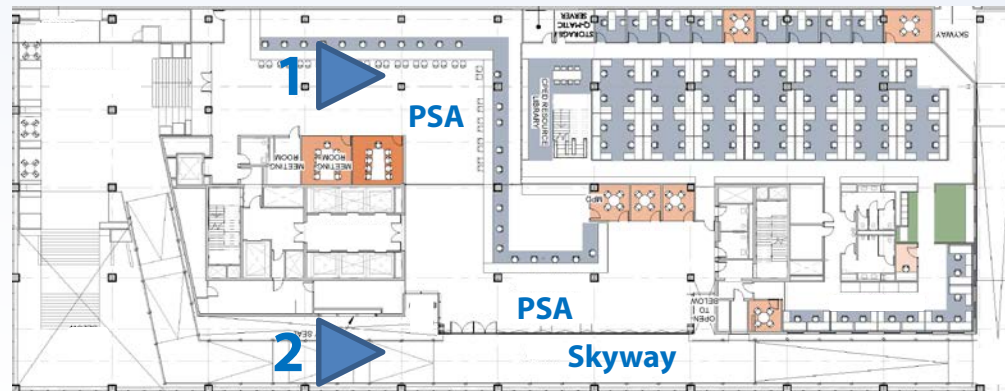

City Staff Workspace

MPD Forensic Lab
MPD Investigations
IT
Finance & Treasury
Regulatory Services
Health Department
Public Works
311
CPED

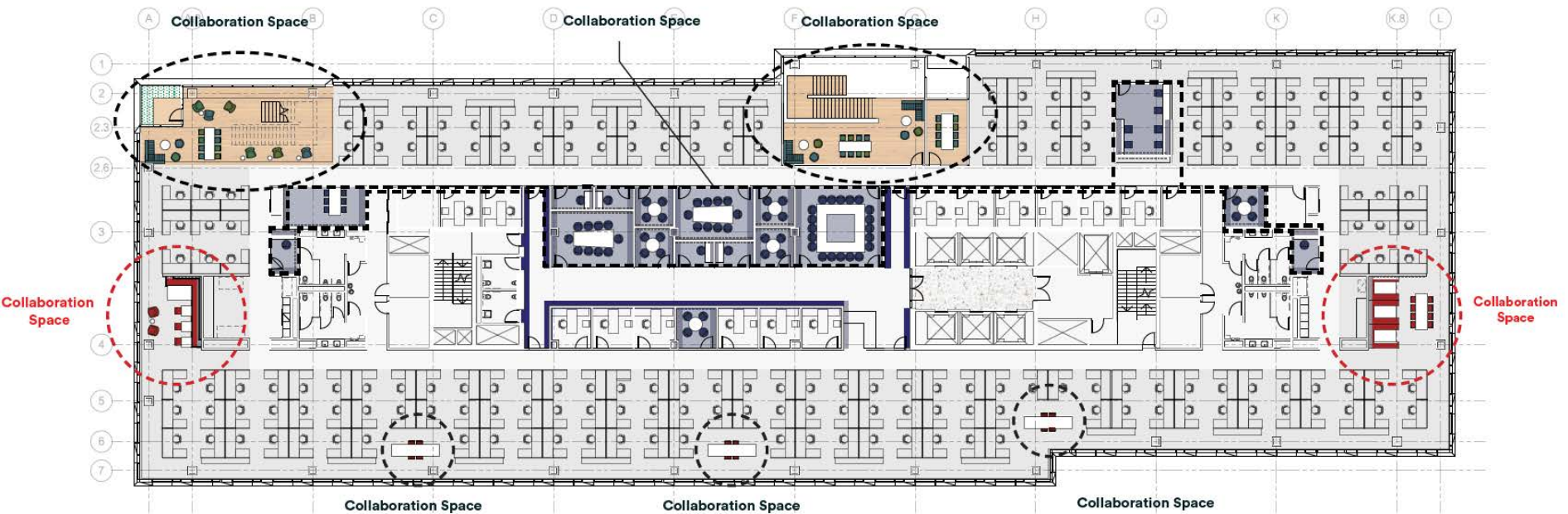

Project Timeline

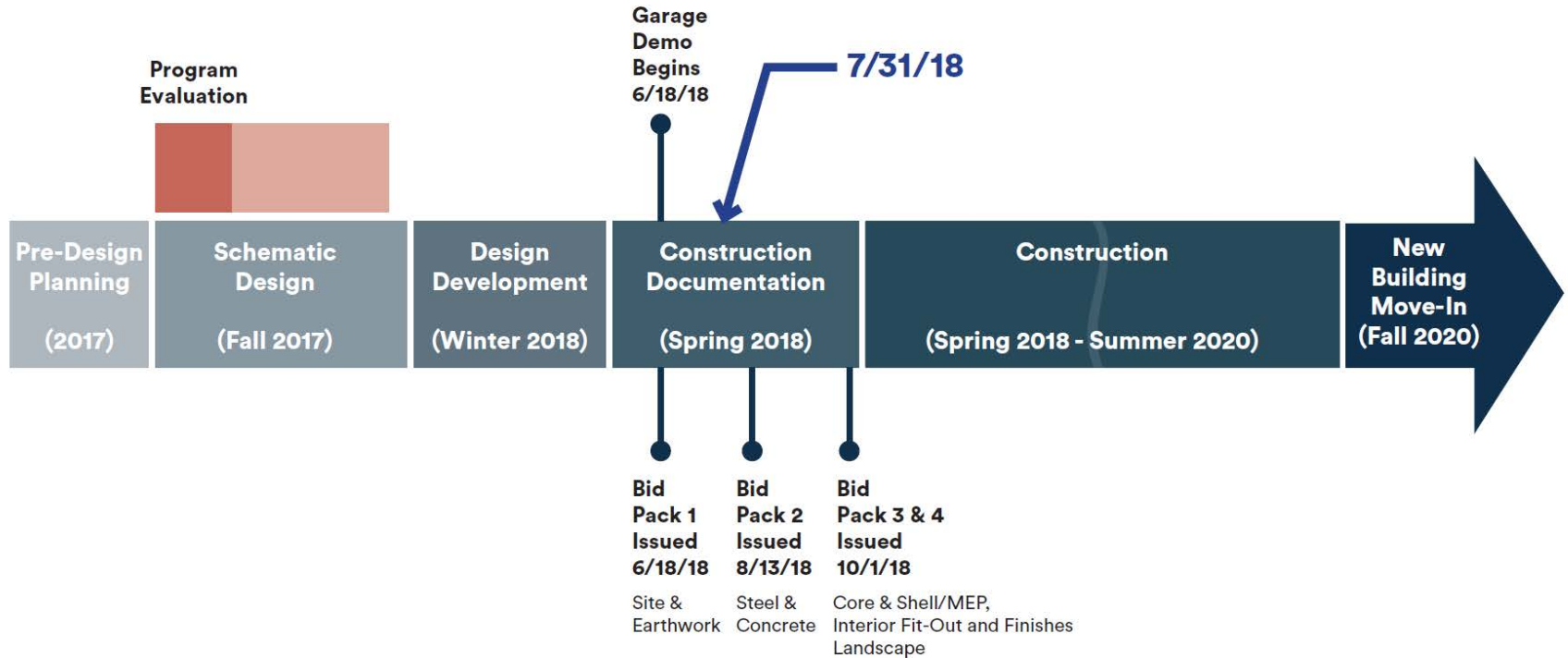



- Design Previews in Spring 2019
- Individual Engagement Events for Each Public Art Project 2018-2019

Next Steps