

LEGEND	
	ROADWAY CLOSURE
	ROADWAY DETOUR ROUTE
	ROADWAY CLOSURE (BY OTHERS)
	DETOUR SIGN
	TYPE III BARRICADE
	LOW INTENSITY WARNING FLASHER, TYPE A

TRAFFIC CONTROL SIGN TABULATION			
SIGN LEGEND	SIGN DESIGNATION	SIZE (IN)	SIGN COLOR
	R11-2	48 X 30	BLACK ON WHITE
	*WZ-1	102 X 36	BLACK ON ORANGE
	G20-X1	54 X 48	BLACK ON ORANGE
	*WZ-3	96 X 72	BLACK ON ORANGE
	W20-2	48 X 48	BLACK ON ORANGE
	W20-3	48 X 48	BLACK ON ORANGE
	*WZ-2	60 X 12	BLACK ON ORANGE
	M4-8A	30 X 24	BLACK ON ORANGE
	M4-9M (ATL)	30 X 24	BLACK ON ORANGE
	M4-9ML	30 X 24	BLACK ON ORANGE
	M4-9M (ATR)	30 X 24	BLACK ON ORANGE
	M4-9MR	30 X 24	BLACK ON ORANGE
	M4-9M	30 X 24	BLACK ON ORANGE

SEE SHEET 26 FOR SIGN DETAIL.

TRAFFIC CONTROL NOTES

ALL TRAFFIC CONTROL DEVICES, SIGNAGE, TEMPORARY PAVEMENT AND BARRICADES SHALL BE PROVIDED AND MAINTAINED BY THE CONTRACTOR FOR ALL PHASES OF WORK. PAYMENT FOR THESE ITEMS ON ALL PHASES OF CONSTRUCTION SHALL BE MADE UNDER BID ITEM 2563.601, TRAFFIC CONTROL (LUMP SUM). NO ADDITIONAL COMPENSATION FOR TRAFFIC CONTROL, SIGNAGE, TEMPORARY AGGREGATE SURFACED ACCESS, PAVEMENT MARKINGS OR BARRICADES WILL BE MADE REGARDLESS OF THE QUANTITY OF ITEMS REQUIRED FOR THE WORK.

THE CONTRACTOR SHALL DEVELOP AND PROVIDE AN ALTERNATE PEDESTRIAN ROUTE (APR) FOR ALL LOCATIONS/ OCCURRENCES THAT PEDESTRIAN ACCESS IS BLOCKED OR IMPACTED BY CONSTRUCTION. REFER TO MNDOT WEBSITE (<http://www.dot.state.mn.us/trafficeng/workzone/cpr.html>) FOR STANDARDS, GUIDANCE AND OPTIONS. ALL MATERIALS, LABOR AND EQUIPMENT NECESSARY TO INSTALL, MAINTAIN, RELOCATE, AND REMOVE THE ALTERNATE PEDESTRIAN ROUTE SHALL BE PAID FOR UNDER BID ITEM 2563.601 ALTERNATE PEDESTRIAN ROUTE (LUMP SUM). SEE SPECIAL PROVISIONS FOR ADDITIONAL DISCUSSION AND REQUIREMENTS.

THE CONTRACTOR SHALL COORDINATE TRAFFIC CONTROL WITH THE PENN AVENUE RECONSTRUCTION PROJECT. IMPLEMENT STAGE 1 AT THE START OF CONSTRUCTION. UPON THE COMPLETION OF PENN AVENUE RECONSTRUCTION PROJECT (BY OTHERS), CONTRACTOR SHALL IMPLEMENT STAGE 2.

THE CONTRACTOR SHALL OBTAIN A PERMIT FROM HENNEPIN COUNTY FOR DETOUR SIGNAGE PLACEMENT ALONG HENNEPIN COUNTY ROUTES OUTSIDE THE CITY OF MINNEAPOLIS.

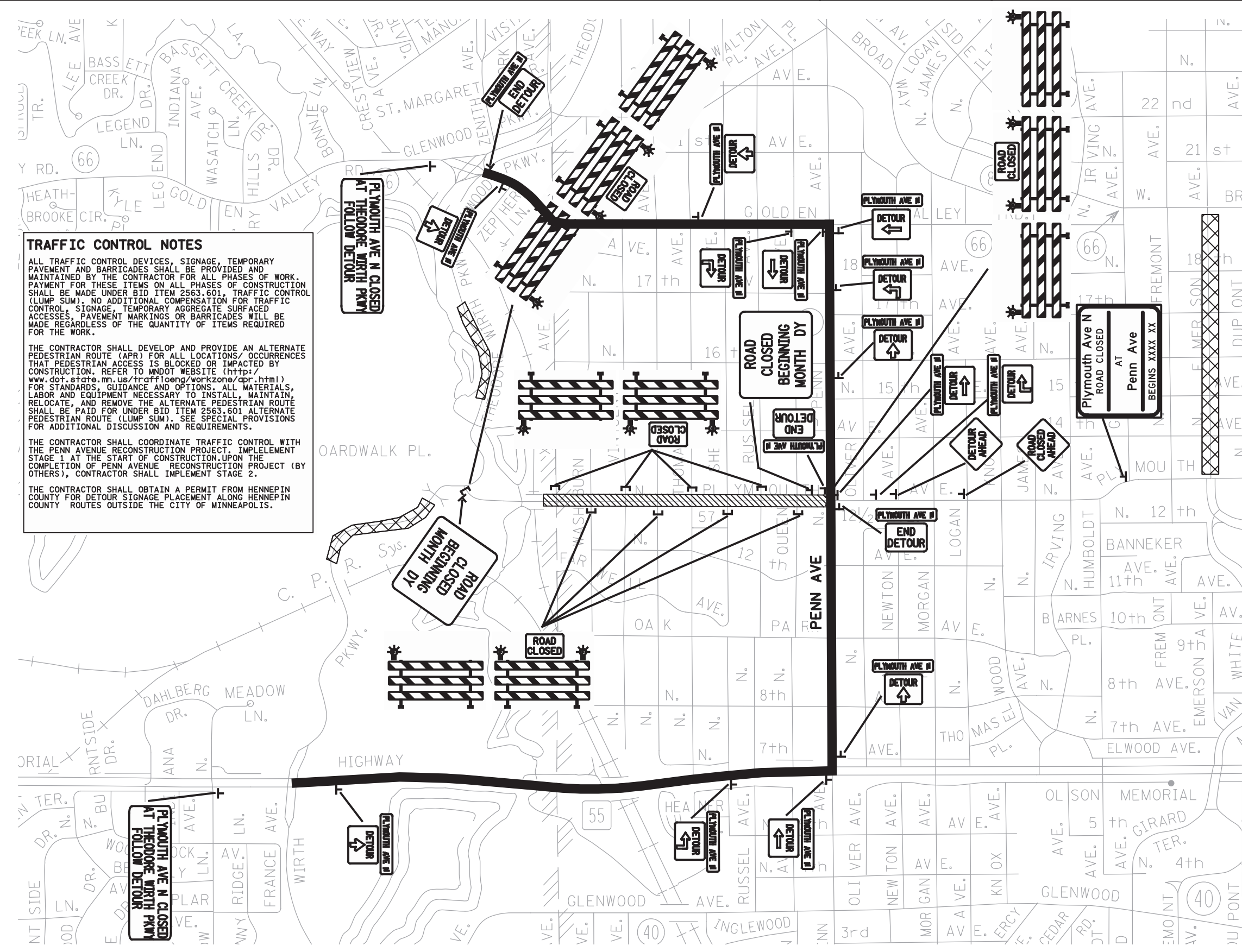

7:20:14 PM 1/27/2021 H:\Projects\13000\13148\Des\ign\PlanSheets\Final\Plan\13148_d102.dgn

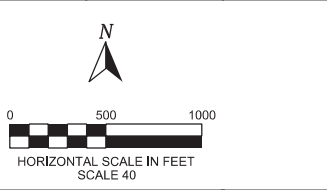

NO.	DATE	DRW	CKD	APP	REVISION

I HEREBY CERTIFY THAT THIS PLAN, SPECIFICATION, OR REPORT WAS PREPARED BY ME OR UNDER MY DIRECT SUPERVISION AND THAT I AM A DULY LICENSED PROFESSIONAL ENGINEER UNDER THE LAWS OF THE STATE OF MINNESOTA.

Michael J. Mohs
Michael J. Mohs 43559 12/16/2020
LIC. NO. DATE



DETOUR LAYOUTS (STAGE 2)	
DRW: LMK	DATE: 12/16/2020
CHK: WFS	DATE: 12/16/2020
APP: MJM	DATE: 12/16/2020

PLYMOUTH AVE N
STREET RECONSTRUCTION

LP 600D 6771
SAP 141-197-025