

Hennepin Ave S Reconstruction Project

(W Lake St. to 26th St)

Construction & Traffic Impact Update

May 18 - 24, 2025

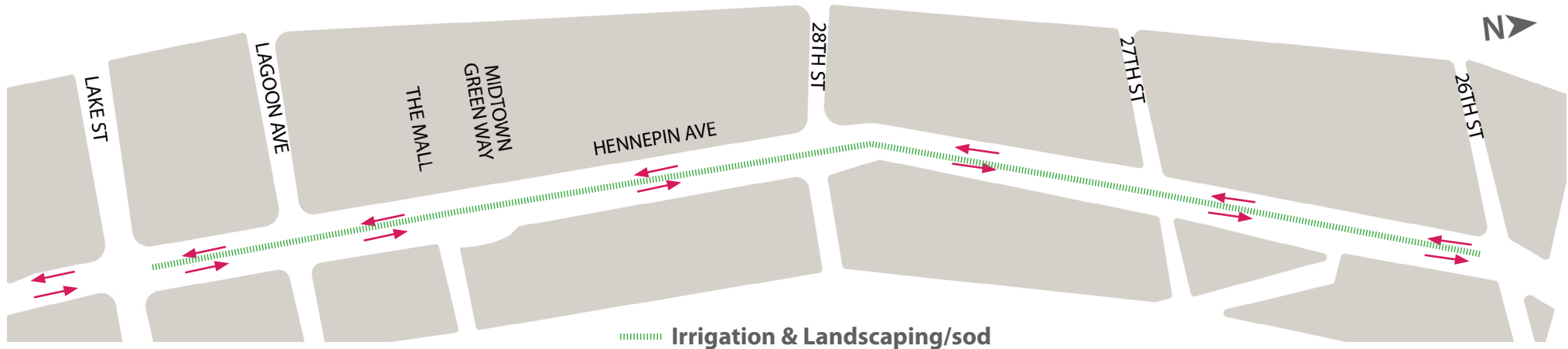

Construction work: Partial Intersection Restriction Sanitary Sewer Conduit Work Storm Sewer

Traffic impact: Lane Closures/Work Zone Travel Lanes Roadway Closure Roadway & Sidewalk work

Page 1



WHAT'S HAPPENING

Lake St to 26th St

- Hennepin Ave is open to traffic.
- Buses have returned to Hennepin
- There will be misc. work in the area during the spring months
- Planter rail installation will continue on Phase 1 around all planter boxes.
- Irrigation start up will begin followed by remaining landscaping and plantings/sod



WHAT TO EXPECT

Lake St to 26th St

- Roadway and utility punchlist work and final landscaping will occur in the spring months. This will require periodic short term closures of the bus/parking lane during the day.
- Cross streets will at times be reduced to 1-lane.
- Parking lanes will be closed at certain locations on side streets.
- Business access will remain open during the construction.
- Pedestrian detours will be set up as needed. Greater impacts can be expected at intersections where work is occurring.



STAY CONNECTED

Visit the project website

Sign up for project updates on the project website.

[Minneapolismn.gov/government/projects/hennepin-ave-s/](https://minneapolismn.gov/government/projects/hennepin-ave-s/)



CONTACT US

Adam Hayow, Project Engineer - Public Works

📞 612-673-2172 📧 adam.hayow@minneapolismn.gov

Hennepin Ave S Reconstruction Project

(W 26th St. to Douglas Ave)

Construction & Traffic Impact Update

May 18 - 24, 2025

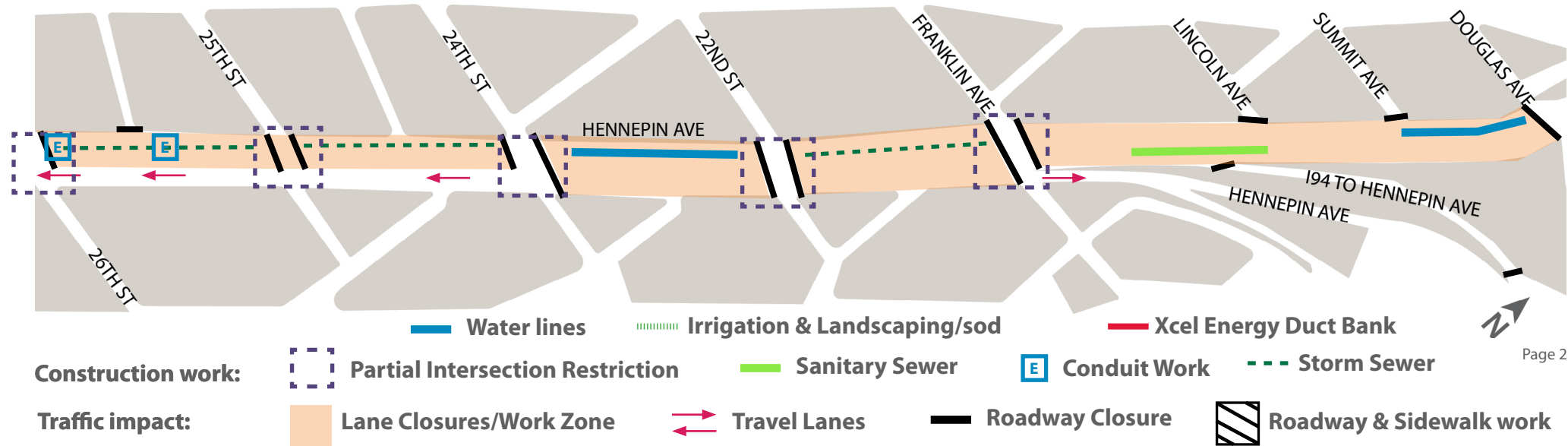

Page 2



WHAT'S HAPPENING

26th St to Douglas Ave

- Roadway construction has begun. This work includes removals, sawcutting, grading, storm sewer work and water service replacement
- Hennepin is closed from Douglas to 24th-Work is being done to replace hydrants, water services, storm sewer and sanitary sewer structure reconstructs.



WHAT TO EXPECT

26th St to Douglas Ave

- Roadway & Utility work using heavy equipment will increase noise, vibration, and dust in work areas and sidewalks.
- Cross streets will at times be reduced to 1-lane or closed to traffic.
- Parking lanes will be closed at certain locations on side locations.
- Business access will remain open during the construction.
- Pedestrian detours will be set up as needed. Greater impacts can be expected at intersections where work is occurring.
- Traffic Delays in the area, closures, and detours.



STAY CONNECTED

Visit the project website

Sign up for project updates on the project website.

[Minneapolismn.gov/government/projects/hennepin-ave-s/](https://minneapolismn.gov/government/projects/hennepin-ave-s/)



CONTACT US

Adam Hayow, Project Engineer - Public Works

612-673-2172 | adam.hayow@minneapolismn.gov

Hennepin Ave S Reconstruction Project

(W Lake St. to Douglas Ave.)

Block-by-Block Work Summary

May 18 - 24, 2025



STREET BLOCK	PROJECT RELATED WORK	ANTICIPATED ROAD/PEDESTRIAN RESTRICTIONS				
		TEMPORARY PED RAMP	PARKING RESTRICTIONS	TWO LANES OPEN (5-9 AM + 3-7 PM)	ONE LANE OPEN	NOTES
Lake St. Intersection						
Lake St. - Lagoon Ave	Sod, & Plantings					
Lagoon Ave Intersection						
Lagoon Ave -29th St.	Sod, & Plantings					
29th St. Intersection						
29th St. - 28th St.	Sod, & Plantings					
28th St. Intersection						
28th St. - 27th St.	Sod, & Plantings					
27th St. Intersection						
27th St - 26th St.	Sod, & Plantings					
26th St. Intersection						
26th St. -25th St.	Storm Sewer, and electrical conduit installations	X	X		X	Single Business access lane south bound
25th St. Intersection		X	X			
25th St - 24th St.	Storm Sewer and Water service replacements	X	X		X	Single Business access lane south bound
24th St. Intersection		X	X			
24th St. - 22nd St.	Water main offset and replacements		X		X	Closed
22nd St. Intersection		X	X			
22nd St. - Franklin Ave.	Storm Sewer		X			Closed
Franklin Ave. Intersection			X			
Franklin Ave -Lincoln Ave.	Sanitary Reconstructs		X			Closed
Lincoln Ave. Intersection	Sanitary Reconstructs	X	X			Closed
Lincoln Ave. - Summit Ave.			X			Closed
Summit Ave. Intersection		X	X			Closed
Summit Ave. - Douglas Ave.	Water services and hydrant work		X			Closed

Hennepin Ave S Reconstruction Project

(W Lake St. to Douglas Ave.)

Detour Routes
May 18 - 24, 2025



PHASE 2



Local / Business
Access Only
1 Lane Southbound

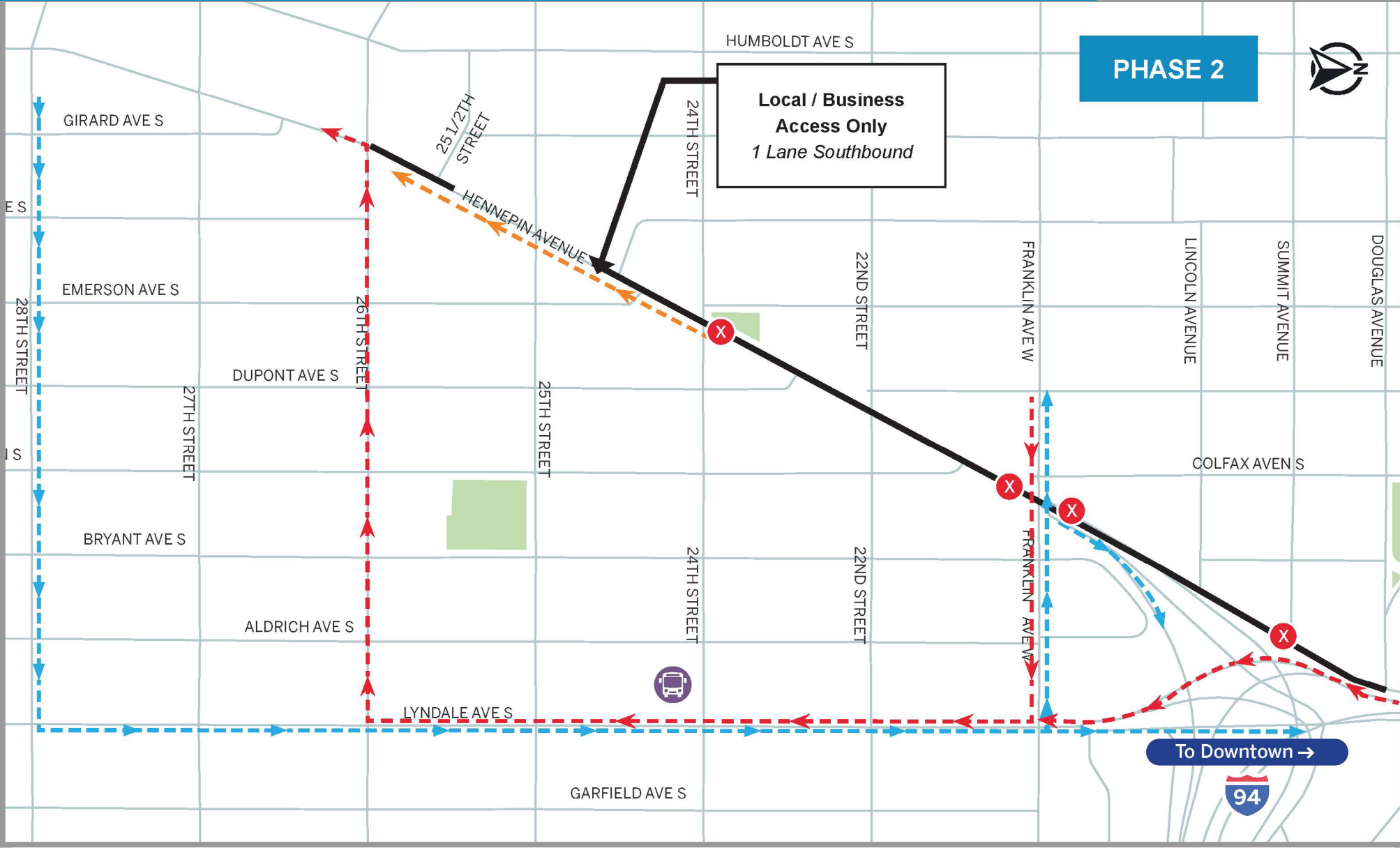

- Detour Route N
- Detour Route S
- Phase 2 Construction zone
- Business Access Route
- Road Closed
- Bus Detour

Hennepin Ave S Reconstruction Project

(W Lake St. to Douglas Ave.)

Business Parking / Access

May 18 - 24, 2025

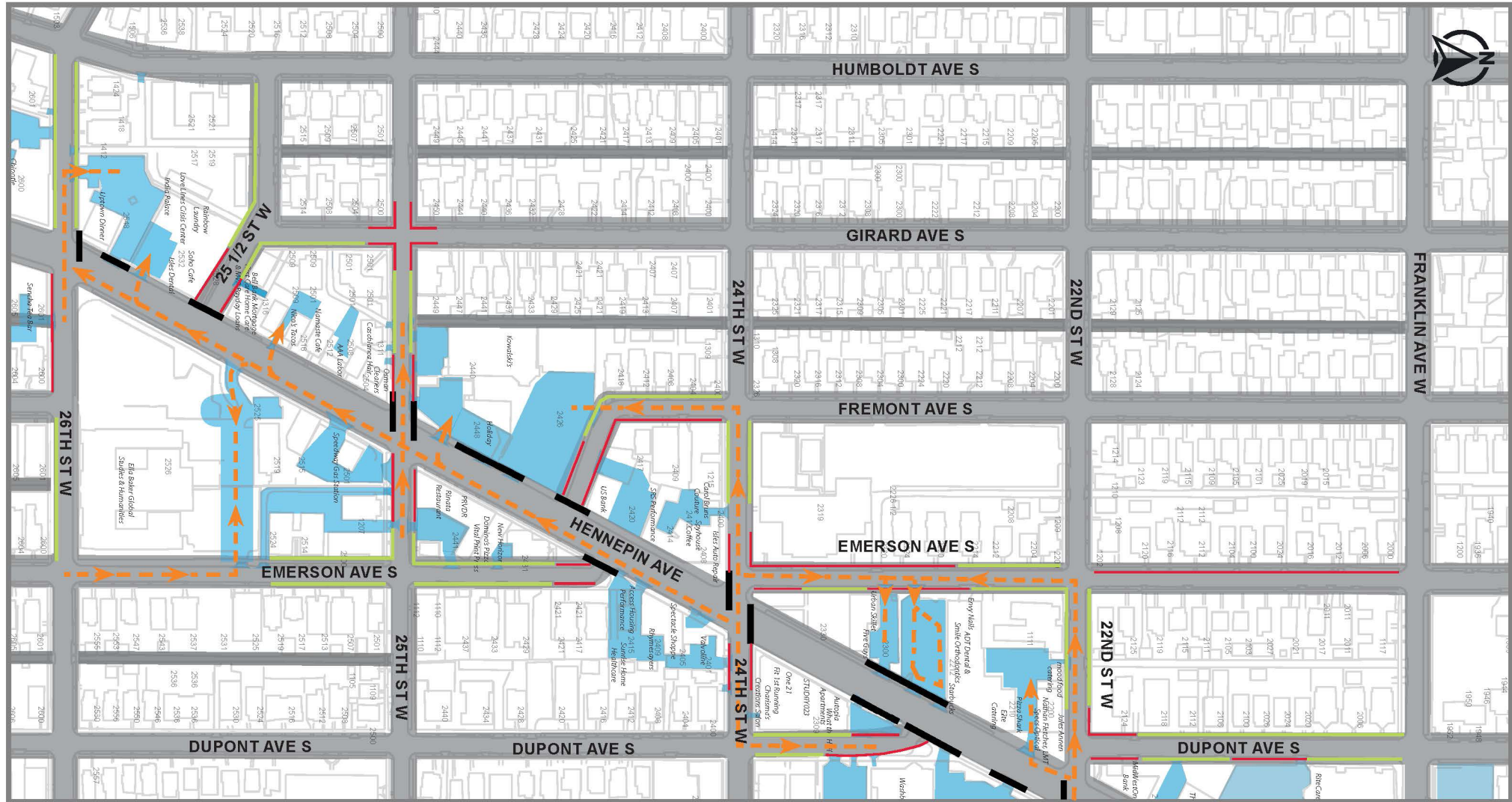

- Private/Business parking
- No Parking
- Onstreet Parking
- Road or Access Closed
- Business Access Route

Hennepin Ave S Reconstruction Project

(W Lake St. to Douglas Ave.)

Business Parking / Access

May 18 - 24, 2025

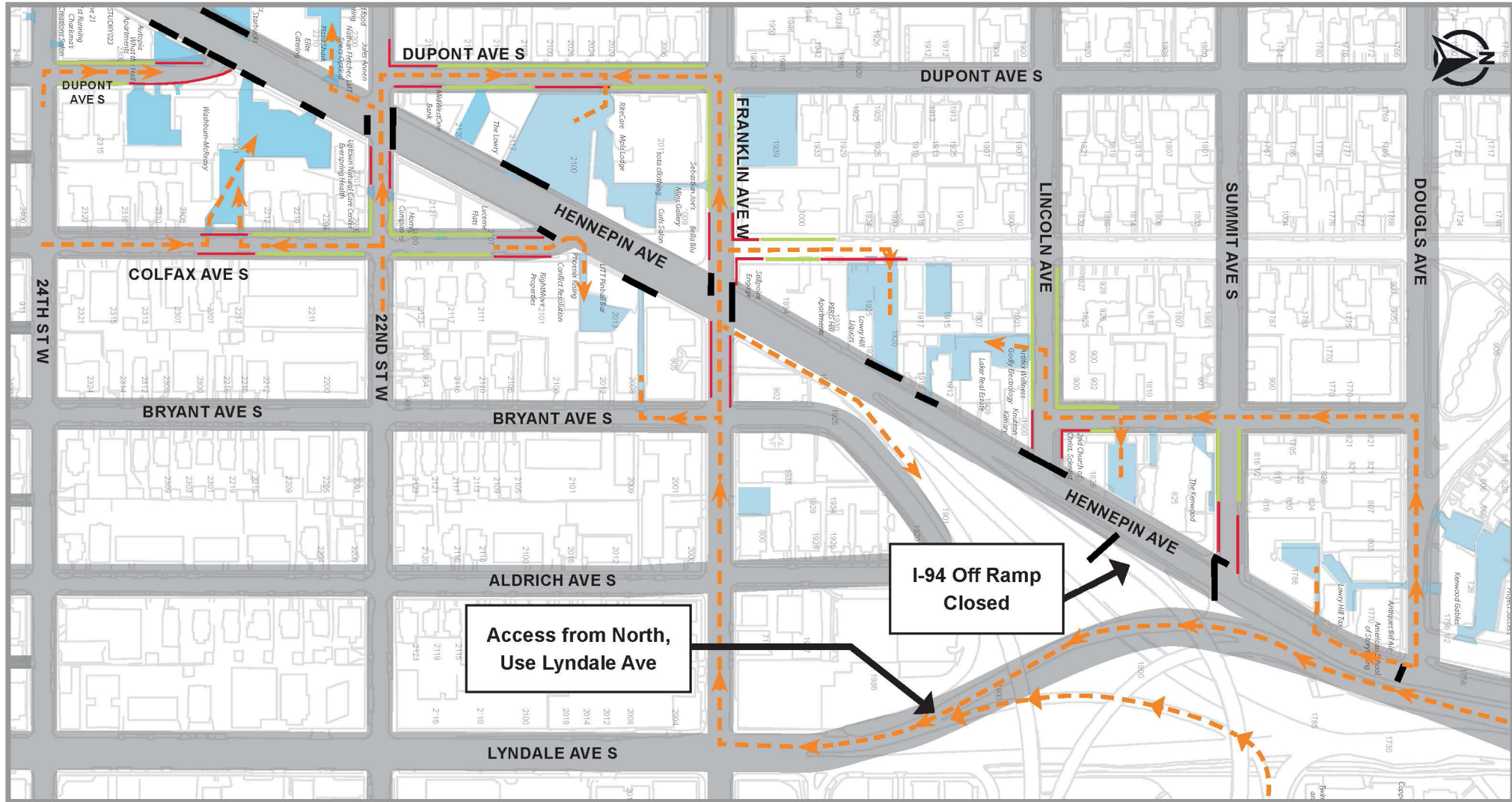

- Private/Business parking
- No Parking
- Onstreet Parking
- Road or Access Closed
- Business Access Route