

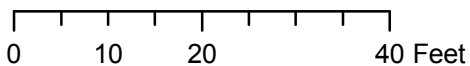

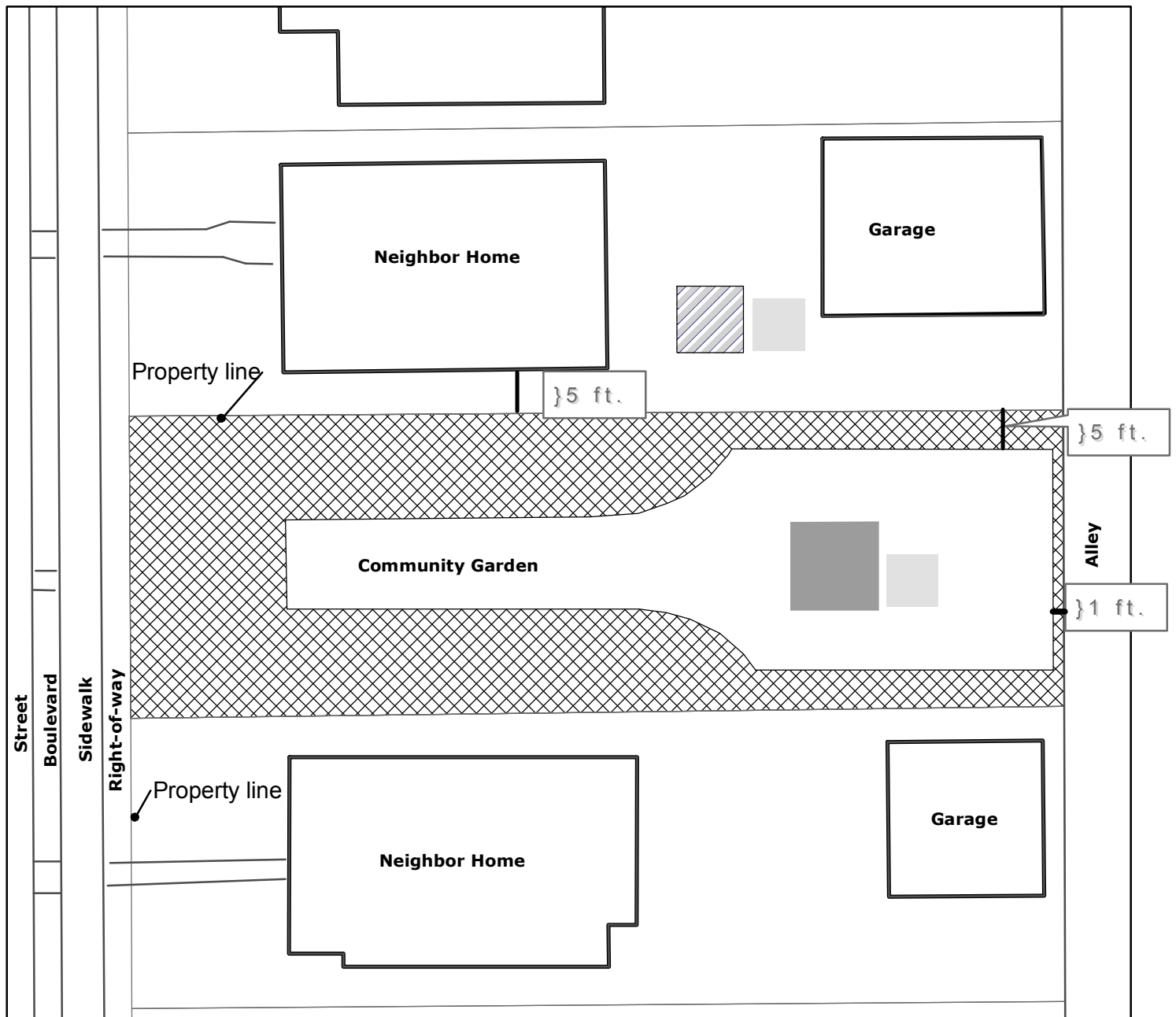



Compost Ordinance Amendment

Sample Site Plan - 5,000-10,000 sq. ft. lot



-  **Compost container prohibited**
-  **Existing ordinance (250 Cubic ft)**
-  **Proposed ordinance, with residence, 405 ft³ (9'x9'x5')**
-  **Proposed ordinance, without residence, 720 ft³ (12'x12'x5')**
-  **Existing Structure**

