

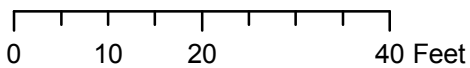

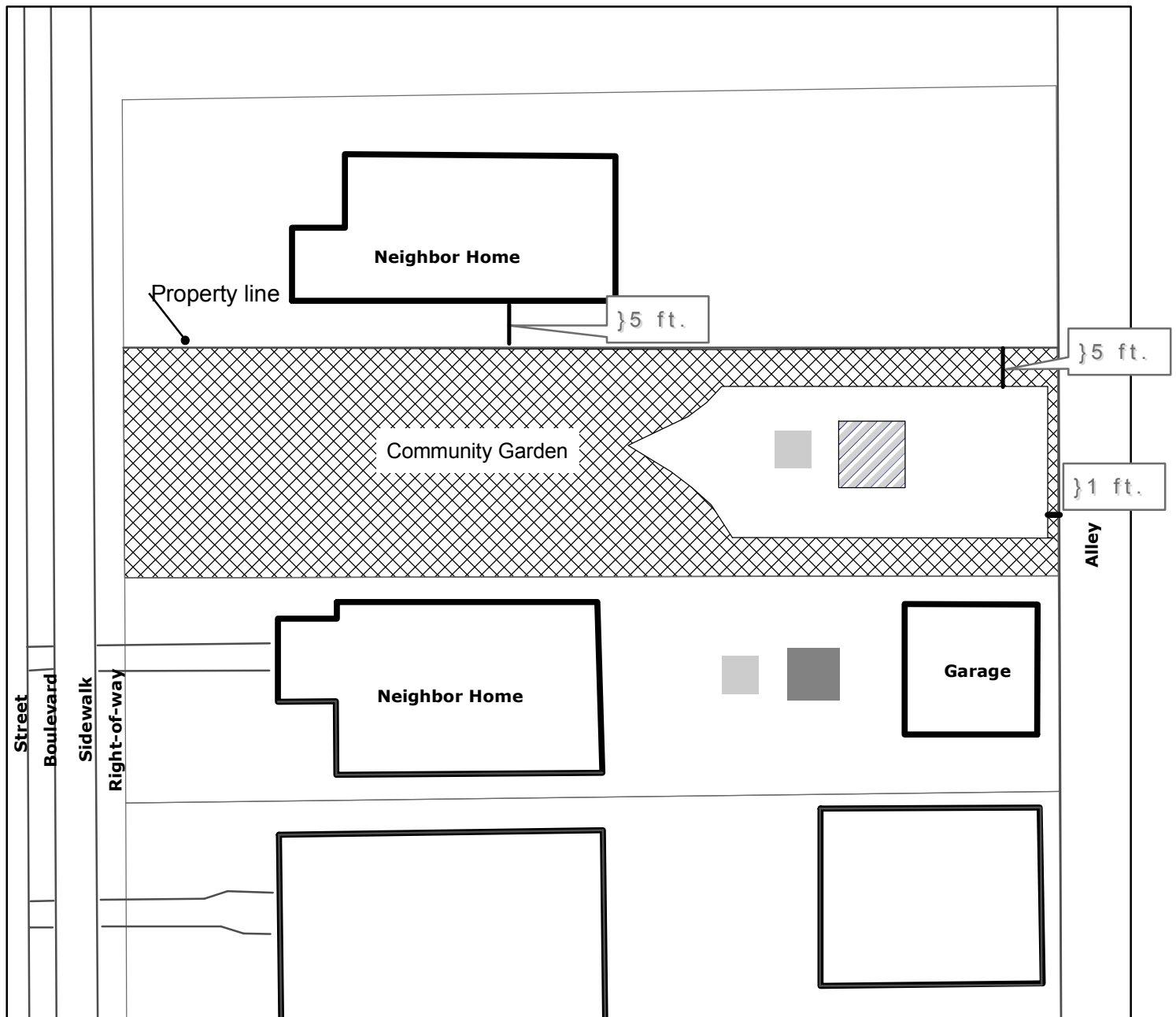



Compost Ordinance Amendment Sample Site Plan - <5,000 sq. ft. lot



-  **Compost container prohibited**
-  **Existing ordinance (125 cubic ft)**
-  **Proposed ordinance, with residence 245 ft³ (7'x7'x5')**
-  **Proposed ordinance, without residence, 405 ft³ (9'x9'x5')**
-  **Existing Structure**

